

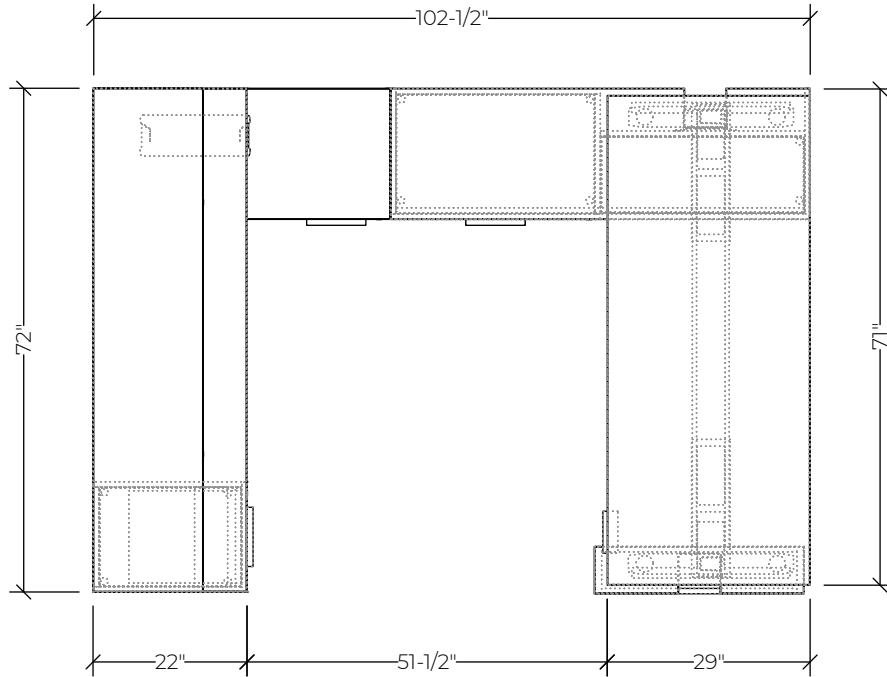

Please refer to page 2 for list pricing information.

Pricing is for budgetary reference only and is subject to change. Availability of finishes and materials may vary due to manufacturer lifecycle updates. Explore more Idea Starters at www.brc.group.



| # | Catalogue Part Number | Description | Quantity | List | Ext. List |
|----|-----------------------------|--|----------|--------------|-------------|
| 1 | FIL FACS5.625 | Spacer Bracket | 1 | \$232.00 | \$232.00 |
| 2 | FIL FAMLAW46H12 | Modesty Panel, Laminate 46Wx12H, Laminate | 1 | \$600.00 | \$600.00 |
| 3 | FCFAZW42D18.75H22M3R | Low Credenza BF Pedestal & Open Storage, Full Front, 42Wx18.75Dx22H, M3 Laminate, Right Hand | 1 | \$1,630.00 | \$1,630.00 |
| 4 | FIL FEFBDW36H22G1 | Element Desk Height Filler Fabric Panel 36Wx22H, Grade 1 | 2 | \$400.00 | \$800.00 |
| 5 | FIL FFCSZW60D18.75H22M3F30L | Integrated Leg Credenza - 22"H with Full Front, 60Wx18.75Dx22H, M3 Laminate, Left Hand | 1 | \$2,564.00 | \$2,564.00 |
| 6 | FIL FFSSZW6.75D30H22M3L | Height Adjustable Leg Surround - 22"H, 6.75Wx30D, M3 Laminate, Left Hand | 1 | \$825.00 | \$825.00 |
| 7 | FIL FSUMZW15.75D22H28 | Undermount Pedestal 2 Box 1 File With Full Front, 15.75Wx22Dx28H | 1 | \$1,095.00 | \$1,095.00 |
| 8 | FIL FTOPNW72D22M1 | Component Worksurface & Panel 72Wx22D, M1 Laminate | 1 | \$421.00 | \$421.00 |
| 9 | FIL FZCLNW72D15.75H15M3 | Wall Mounted Hinged Door Cabinet 72Wx15.75Dx15H, M3 Laminate | 1 | \$1,257.00 | \$1,257.00 |
| 10 | FIL MWSTCW70D29M1 | Mesa Rectangular 2 Leg Electric T Base Table Sit-Stand, 70Wx29D, M1 Laminate | 1 | \$2,431.00 | \$2,431.00 |
| | | | | Total (List) | \$11,855.00 |

Pricing is for budgetary reference only and is subject to change. Availability of finishes and materials may vary due to manufacturer lifecycle updates. Explore more Idea Starters at www.brc.group.