

#12132

# Typical Private Office

---

abrc



#12132

# Typical Private Office



## Technical Specifications

### Specifications

Board Weight: 45lbs medium density

Board Thickness (Case/Fronts): 3/4"

Edge Banding: Polypropylene on all edges

**Hardware:** Slides: box drawers – 100lb rated  
File drawers – 150lb rated

### Environmental Specs:

Indoor Air Quality: Clean Air, Gold; BIFMA Level 2

FSC (HPL Tops Only): Optional / Available

PVC: None

**Warranty:** 12-Years / 1 Shift - Limited Structural

### Dealer Considerations

Freight Charges: Refer to BRC freight program

Specification Support: Available

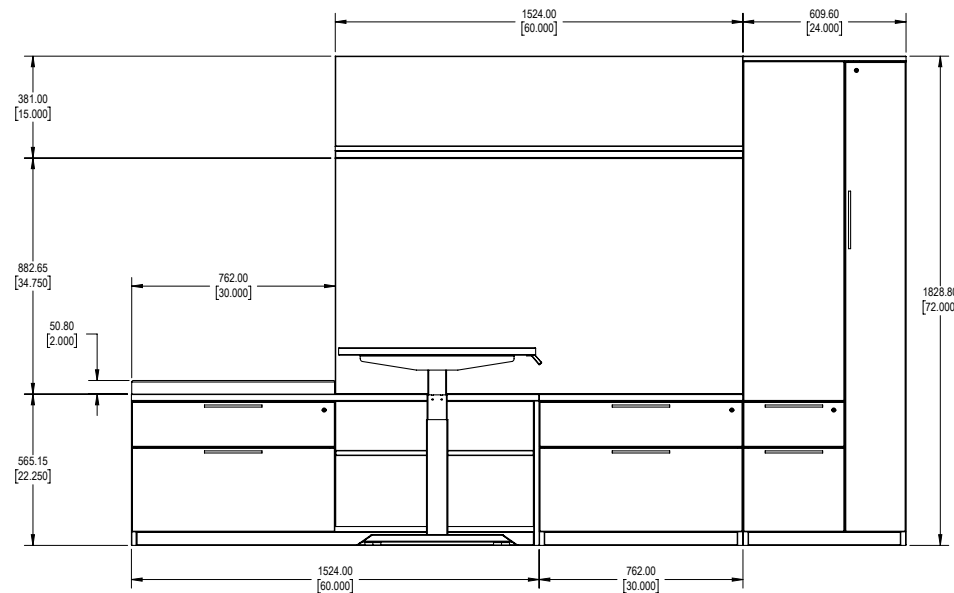
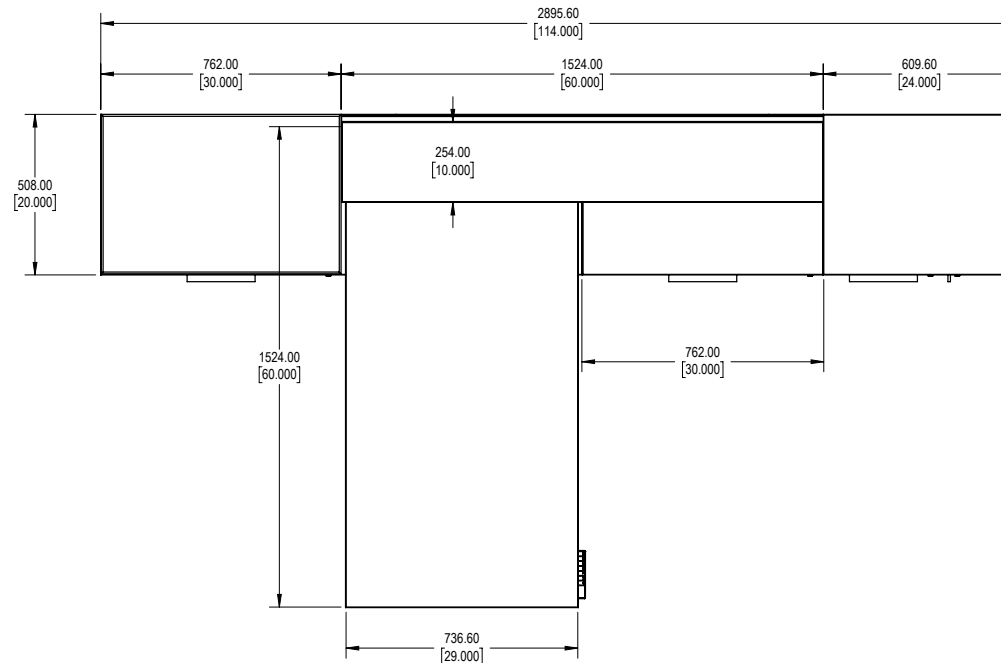

#12132

# Typical Private Office



## List Price

|  |                   |
|--|-------------------|
| <b>NLLSXW30D20H22.25M1</b>   |                   |
| Low Storage, Box File, Recessed Kick .....                                       | 931.00            |
| <b>NEC2NW30D20H2G1</b>   |                   |
| Cushion Top for Credenza Box Style .....   | 467.00            |
| <b>NFCSXW60D20H22.25M1F30L</b>   |                   |
| Integrated Leg Credenza – 22.25”H, Recessed Kick.....                            | 1,967.00          |
| <b>NWEAXW24D20H7M1L</b>  |                   |
| Wardrobe w/ Side Open Storage, Box File Ped, Recessed Kick,<br>Left Handed ..... | 2,110.00          |
| <b>(Custom Code Created on Request)</b>  |                   |
| Cleat Mounted Panel w/ Floating Shelf.....                                       | 478.00            |
| <b>(Custom Code Created on Request)</b>  |                   |
| Element Free Fabric Panel (G1 Fabric) .....                                      | 270.00            |
| <b>MWSTCW60D29M1</b>   |                   |
| Mesa 2 Leg, Height Adjustable Table Sit-Stand. ....                              | 1,762.00          |
| <b>Total .....</b>   | <b>\$7,985.00</b> |

Prices are subject to change without notice.

28/03/2022