

CODELOCKS LTD UK

Tel: +44 (0) 1635 239645

Fax: +44 (0) 1635 239644

sales@codelocks.co.uk

Helpline, service & spares
FREEPHONE 0800 393405**CODELOCKS INC US**

Tel: +1 714 979 2900

Fax: +1 714 979 2902

sales@codelocks.us

KitLock is a
Codelocks Ltd Brand
www.kitlock.com

WWW.KITLOCK.COM

INSTALLATION GUIDE**A Replace existing cam lock with KitLock**

- | | | | |
|--------|--|---------|--|
| Step 1 | Remove existing cam lock. | Step 8 | Tighten the lower fixing nut and upper bolt. |
| Step 2 | Place the 16mm ($\frac{5}{8}$ ") template hole over the hole left by the cam lock and mark the upper fixing hole. | Step 9 | Select the cam which suits your door and frame and attach it to the square shaft at the end of the spindle. |
| Step 3 | Drill the 6mm ($\frac{1}{4}$ ") fixing hole. | Step 10 | Now check the operation of the lock using the factory User Code 22 44. |
| Step 4 | Fit the KitLock to the door by passing the spindle through the 16mm ($\frac{5}{8}$ ") hole. | Step 11 | If the lock is functioning correctly, CHANGE THE DEFAULT MASTER CODE 11 33 55 77 and DEFAULT USER CODE 22 44 and program the lock using the programming and operating instructions enclosed. |
| Step 5 | If required, from the inside of the door, pass either of the packing pieces over the spindle to centralise the lock. | | |
| Step 6 | Now secure the lock by threading the large nut onto the spindle. | | |
| Step 7 | Fit one of the upper fixing bolts to suit your door thickness. | | |

B New Installation

- | | | | |
|--------|---|--------|---|
| Step 1 | Place template on door and mark upper 6mm ($\frac{1}{4}$ ") hole and lower 16mm ($\frac{5}{8}$ ") hole. IMPORTANT NOTE: Before drilling fixing holes, please ensure the position of the KitLock when fitted will allow enough clearance for selected cam to work. | Step 2 | Drill both fixing holes. |
| | | Step 3 | Continue installation from step 4 to 11, above. |

KL1000

Vertical

**Installation
Instructions**
Kit•Lock
 Coded Locker Solutions

SPECIAL NOTES

FITTING INSTRUCTIONS

Please read carefully:

- Before installing the lock, load the batteries and familiarise yourself with the operation and programming.
- The handle will not turn until you enter the factory default Master Code 11 33 55 77 or the User Code 22 44.
- Please see programming guide to set your own codes.
- Your KitLock is supplied ready to fit to doors up to 19mm ($\frac{3}{4}$ ") thick. For doors between 19mm ($\frac{3}{4}$ ") and 25mm (1") thick, you will need to install the 28.5mm ($1\frac{1}{8}$ ") spare spindle (see below). A 12mm ($\frac{1}{2}$ ") spindle is also included for sheet metal doors (see below).

The KitLock can be fitted to:

A Cabinets, cupboards and lockers etc as a direct replacement for existing cam locks.

B It can also be fitted easily to cupboards and cabinets that do not have an existing locking device.

- 1 KitLock
- 2 Upper fixing bolt x 2
- 3 Packer pieces x 3
- 4 Locking nut
- 5 Cams x 2
- 6 Cam fixing bolt

Batteries – 2 x 1.5V AAA
Template x 1

1. Remove the lower 2 fixing screws.
2. Remove cover plate, spindle and threaded shaft.
3. Replace with spare spindle and threaded shaft.
4. Replace cover plate.

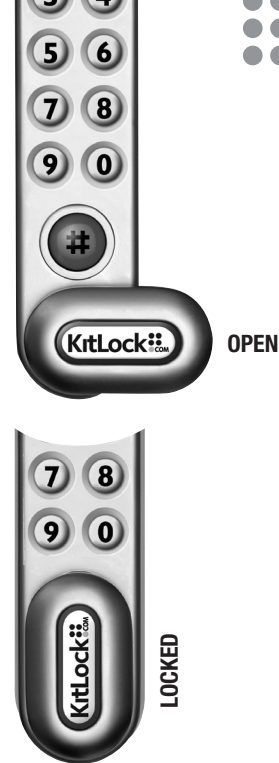
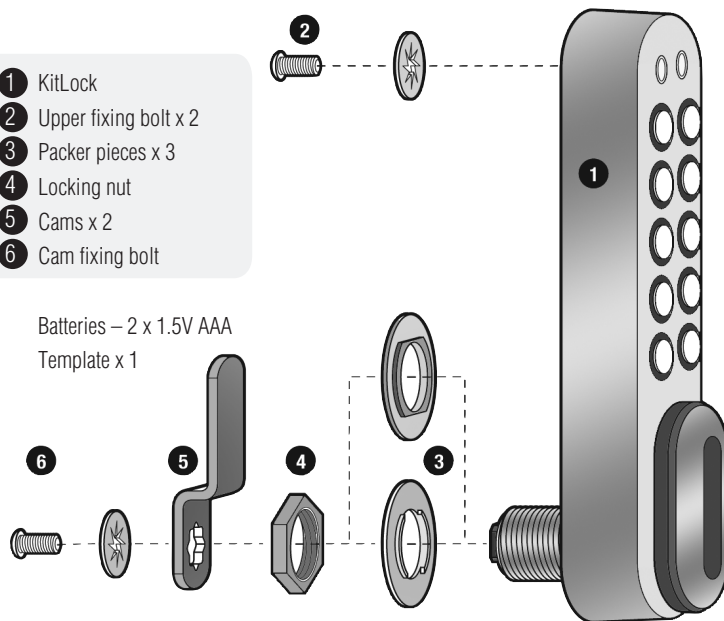
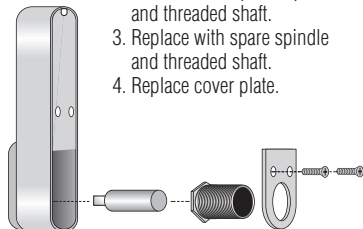

Kit•Lock
Coded Locker Solutions

Please see installation guide on reverse



SAFETY NOTICE

Instability Hazard

Mobile items on casters such as flip top, personal and movable tables of any type and storage items of any type may present an instability hazard if not secured correctly while in use or in storage. Flip top tables or training tables of any type, are inherently more unstable when folded. BRC provides the following guidelines & warnings when using mobile products:

- Lock casters immediately after moving. Do not leave the casters unlocked when in use or in storage.
- Motion may increase the instability of any item with casters. If the wheels hit an obstruction the table's forward momentum often causes overturn, especially if the item is not equipped with wheel extensions. Exercise strong caution while moving these items.
- Use caution when abrupt level changes in the floor are present (such as a doorway or room threshold) as caster failure or tipping may result.
- Do not stand, sit or lean on mobile items for support. They are not intended for this use and personal injury or property damage may result.
- Mobile units that feature height adjustable elements must be lowered to the minimum compressed height when moving to prevent instability. It is also recommended the user remove all computer equipment or other accessories to prevent possible weight imbalance or damage to equipment.
- Failure to follow the guidelines above may result in property damage or personal injury.

Heavy Load

- This product must be anchored to wall to ensure stability & safety.
- It is the owner and installers responsibility to ensure that the wall type and construction is of sufficient strength to carry the loads of any wall mounted products and their contents.
- Failure of the wall and anchors to support all imposed loads may result in property damage or personal injury.
- BRC can provide size and empty weight of its products only. As wall blocking is considered a building construction process, BRC cannot provide recommendations in this respect and cannot be responsible for damage or injury that may occur as a result of improper installation and/or blocking.

Load Bottom Drawer First!

- Operate one drawer at a time.
- Unit may tip if loaded incorrectly.
- Unit should be attached to a wall or other furniture to reduce tipping hazard.
- Always load the heaviest files in the bottom drawer.
- Failure to follow the guidelines above may result in property damage or personal injury.

11/2022