

PO4

## Executive Office with Height Adjustable Table

---



PO4

# Executive Office with Height Adjustable Table

## Specifications

### Specifications

Board Weight: 45lbs medium density  
 Board Thickness (Case/Fronts): 3/4"  
 Edge Banding: Polypropylene on all edges

### Hardware

Slides: box drawers – 100lb rated  
 File drawers – 150lb rated

### Environmental Specs

Indoor Air Quality: Clean Air, Gold; BIFMA Level 2  
 FSC (HPL Tops Only): Optional / Available  
 PVC: None

### Warranty

12-Years / 1 Shift - Limited Structural

### Dealer Considerations

Freight Charges: Refer to BRC freight program  
 Specification Support: Available

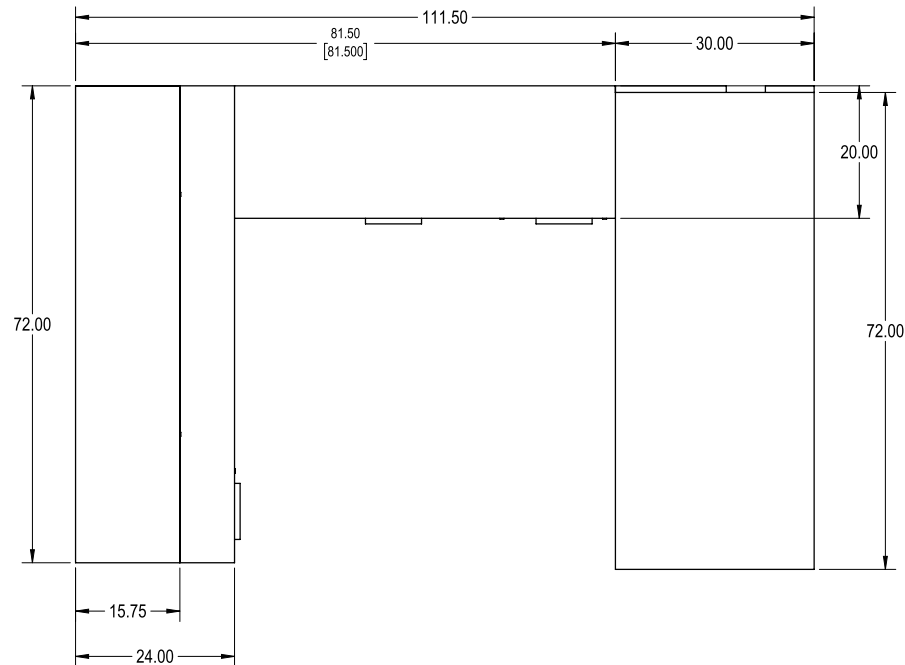

**PO4**

# Executive Office with Height Adjustable Table

---

## List Price

<b>NZCLNW72D15.75H15M1</b> Wall Mounted Hinged Door Cabinet.....	1,100.00	<b>NSLFZW36D20H21.25</b> Low Lateral Box File, No Top, Full Front.....	1,041.00
<b>PDQCUSP_RM21_15716_6N022H</b> Wall Mount White Back Painted Glass .....	3,089.00	<b>NLTSZW30D20H21.25</b> Low Open Storage, No Top, 1" Kick.....	685.00
<b>NTOPNW72D24M1</b> Modular Component Worksurface .....	557.00	<b>SP-NTOPNW81.50D20M1</b> Modular Component Worksurface .....	557.00
<b>SP-NSUMZW15.5D24H28</b> Undermount Pedestal 2 Box 1 File, Full Front .....	842.00	<b>PDQCUSP_RM21_15716_4N0</b> Telescoping Intergrated HA Table with Modesty .....	8,684.00
<b>NACSAH5.625</b> Spacer Bracket.....	204.00	<b>Total.....</b>	<b>\$19,085</b>
<b>SP-NFMSZW30D20H22.25M1</b> Modular Integrated Leg Cabinet - 22.25" High.....	1,510.00		
<b>NSLBZW15.5D20H21.25</b> Low Pedestal Box File, No Top, Full Front .....	816.00		

Prices are subject to change without notice. Last update: 09/2022