

2 Leg Quick Connect Desk

Assembly Instructions

a. Assembly Diagram

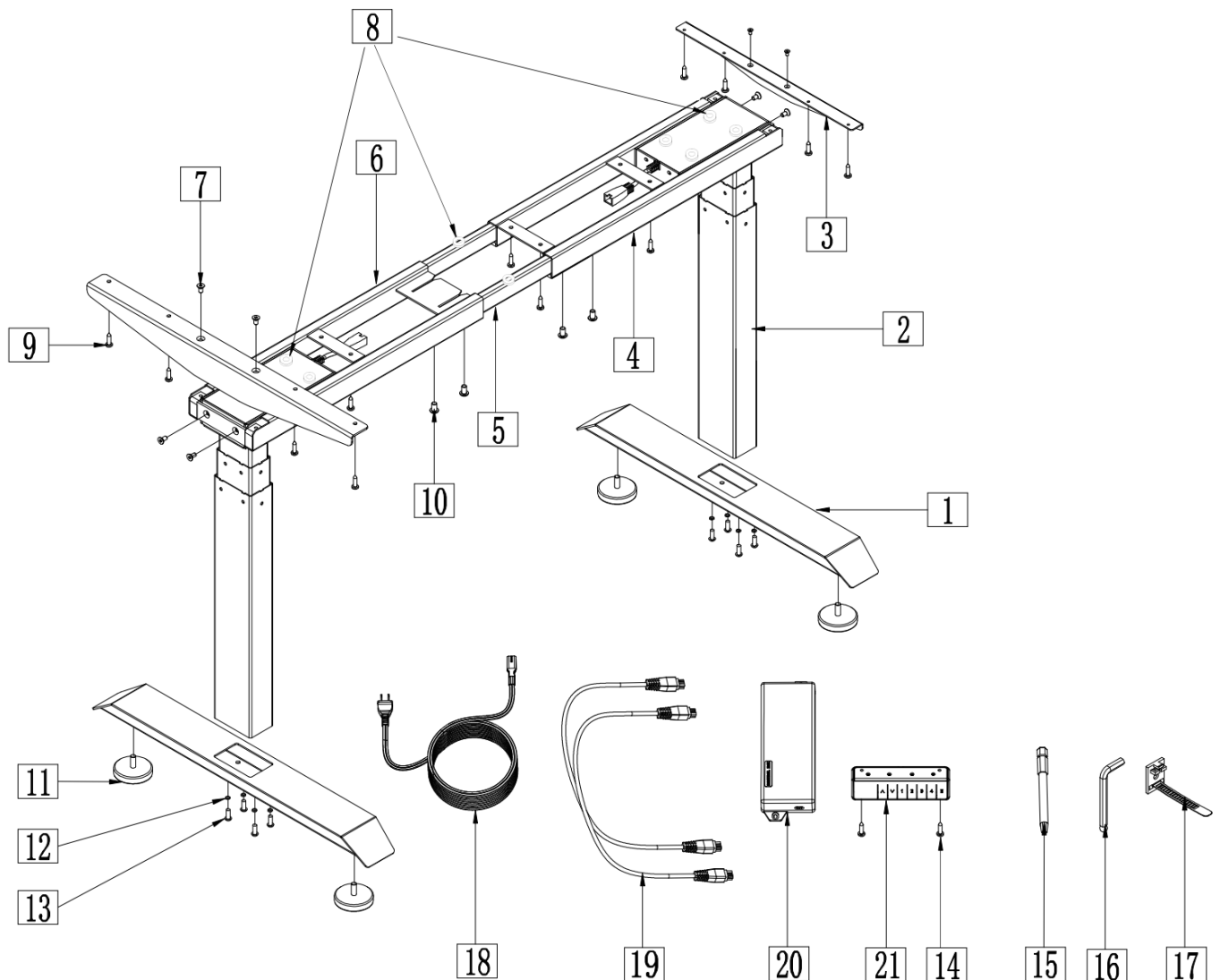

b. Packing list

Base Frame Component

1. Foot	-----	2pcs
2. Lifting Column	-----	2pcs
3. Side Support	-----	2pcs
4. Framework-1	-----	1pcs
5. Extendable Tube	-----	2pcs
6. Framework-2	-----	1pcs

Hardware Components

7. Bolt M6x12	-----	8pcs
8. Rubber Bumper	-----	10pcs
9. Screw #12x3/4	-----	14pcs
10. Bolt M6x10	-----	8pcs
11. Leveling Glides-1"	-----	4pcs
12. Star Washer	-----	8pcs
13. Bolt M6x16	-----	8pcs
14. Screw #8x3/4	-----	7pcs
15. 4mm Hex Bit	-----	1pcs
16. 4mm Hex Wrench- Ball Point	-----	1pcs
17. Cable Tie	-----	5pcs

Electric Components

18. Power Cord-108"	-----	1pcs
19. Patch Cord-59"	-----	2pcs
20. Control Box 2 Outlet	-----	1pcs
21. Handset	-----	1pcs

c. Base Frame Setup.

1. Take out the Framework from carton and extend the outer frame sections.



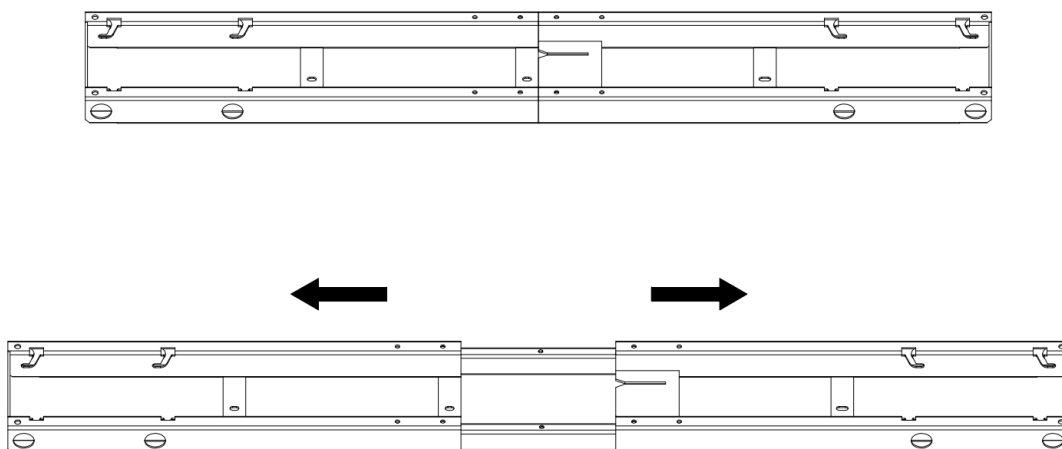

2. Lifting Column is pre-installed with M6x10 bolt. Insert lifting column (Part 2) into the keyway on the Framework (Part 4) then lock in place from the side with Bolt x4 (Part 7, M6x12)

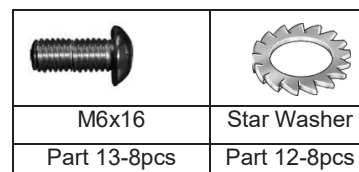
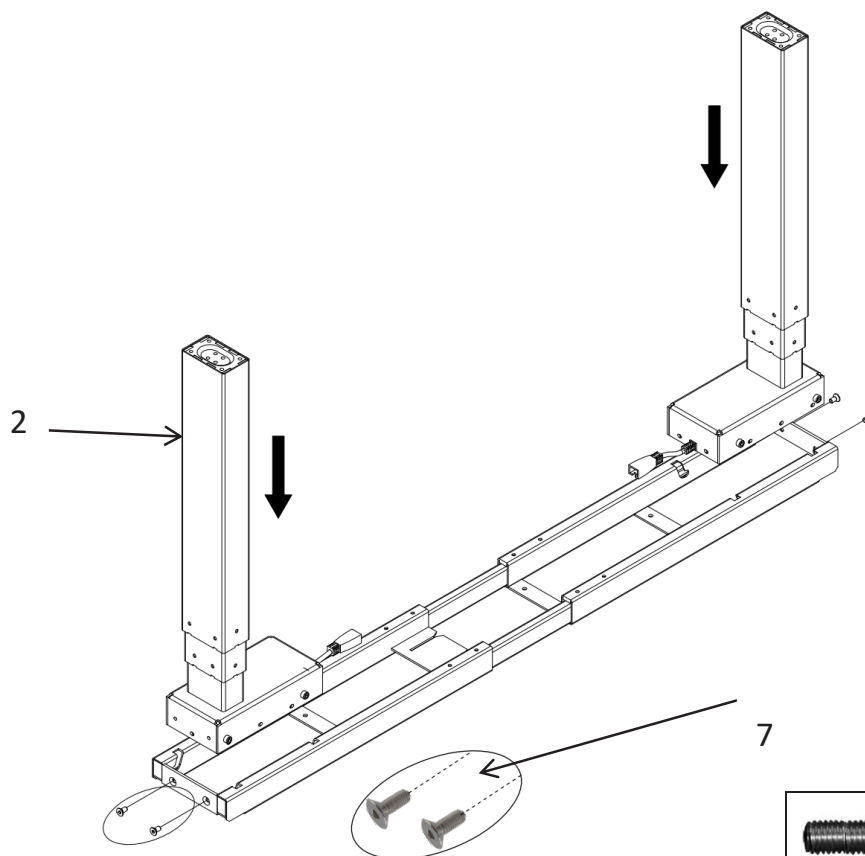

3. Install Leveling Glides x4 (Part 11) to Foot x 2 (Part 1).
4. Install Foot x2 (Part 1) to Lifting Column x2 (Part 2) with Bolt x8 (Part 13, M6x16) and Star Washer x8 (Part 12).

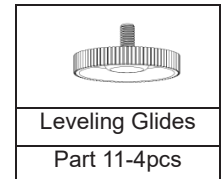
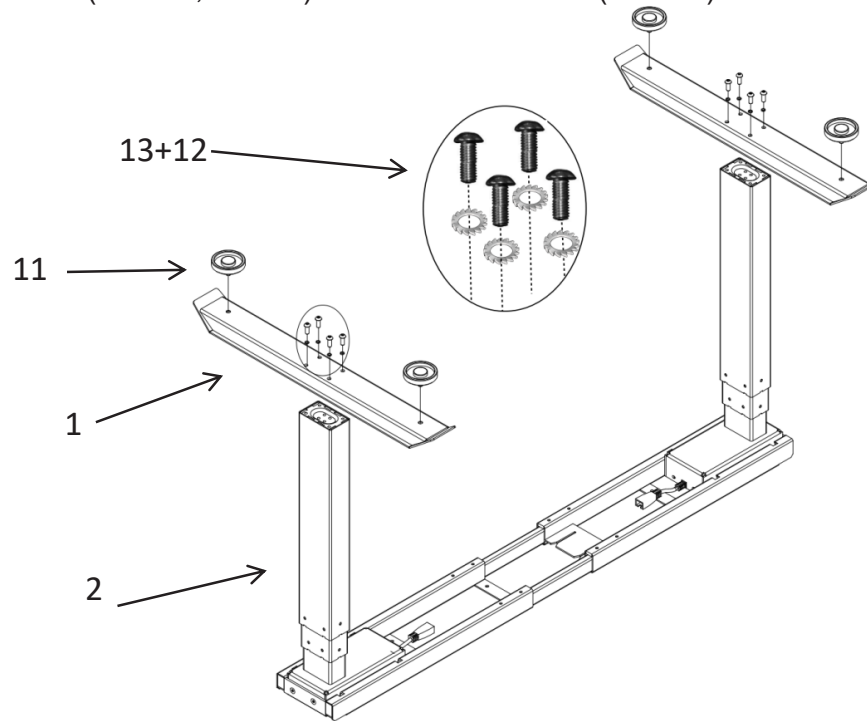

5. Install the Side Support (Part 3) to Framework (Part 4) with Bolt x4 (Part 7, M6x12)
6. Stick Rubber Bumper x10 (Part 8) on top of lifting column and on top of extendable tube.

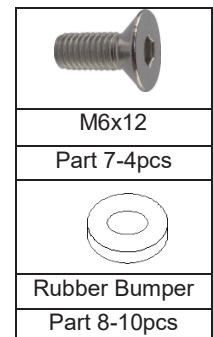
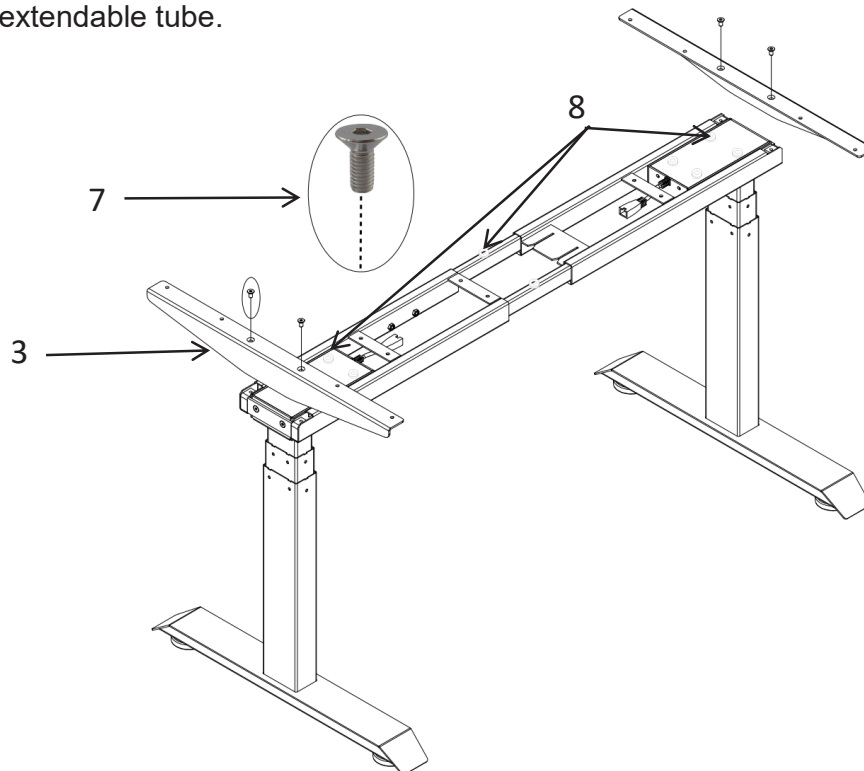

7. Set width of base (DIM B) according to width of tabletop (DIM A) Refer to grid below.
8. Tighten Bolt x8 (Part 10, M6x10) to set the base frame to the correct width.

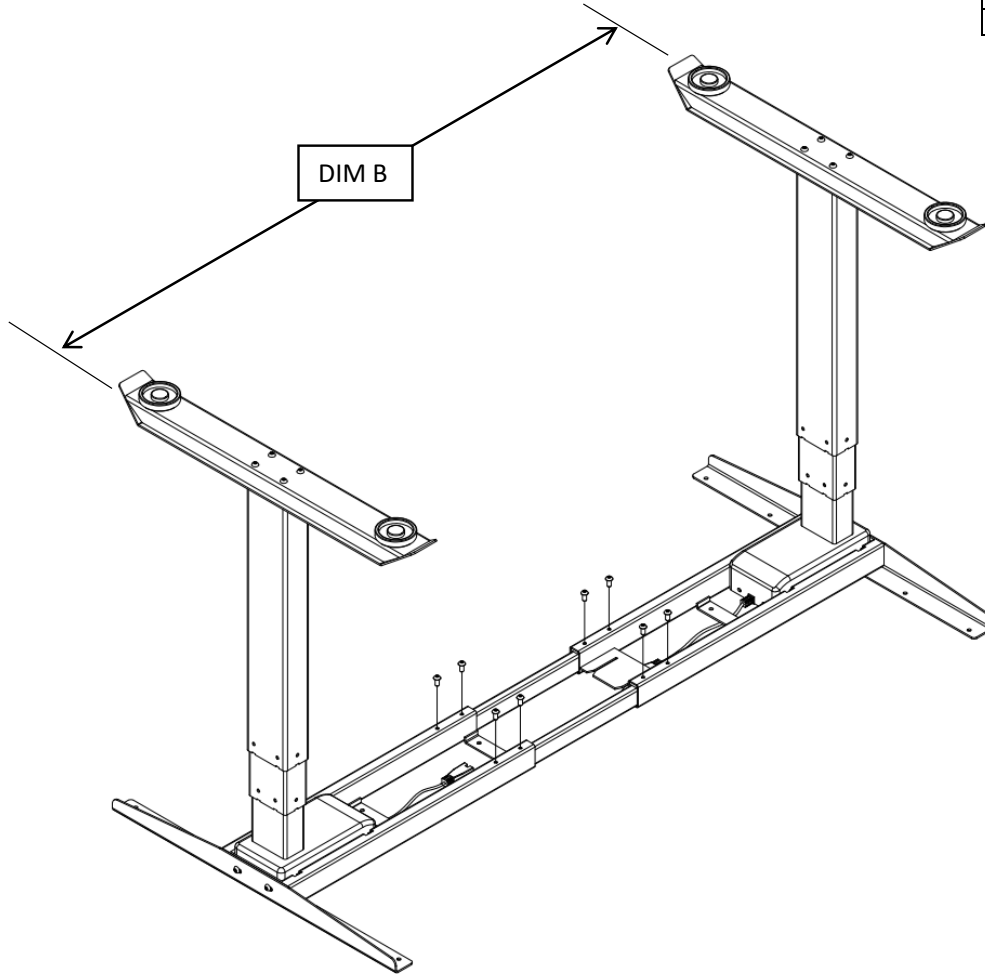
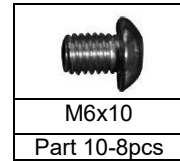

Dimensions	
A	B
Top Width	Base Width
82	71
76	71
70	68
58	56
46	44

9. Hang the Control box x1 (Part 20) on the base.
10. Install Worksurface. Position in the center of top as pictured below.
11. Using Screw x14 (Part 9, #12x3/4) to attach the base to the table top.

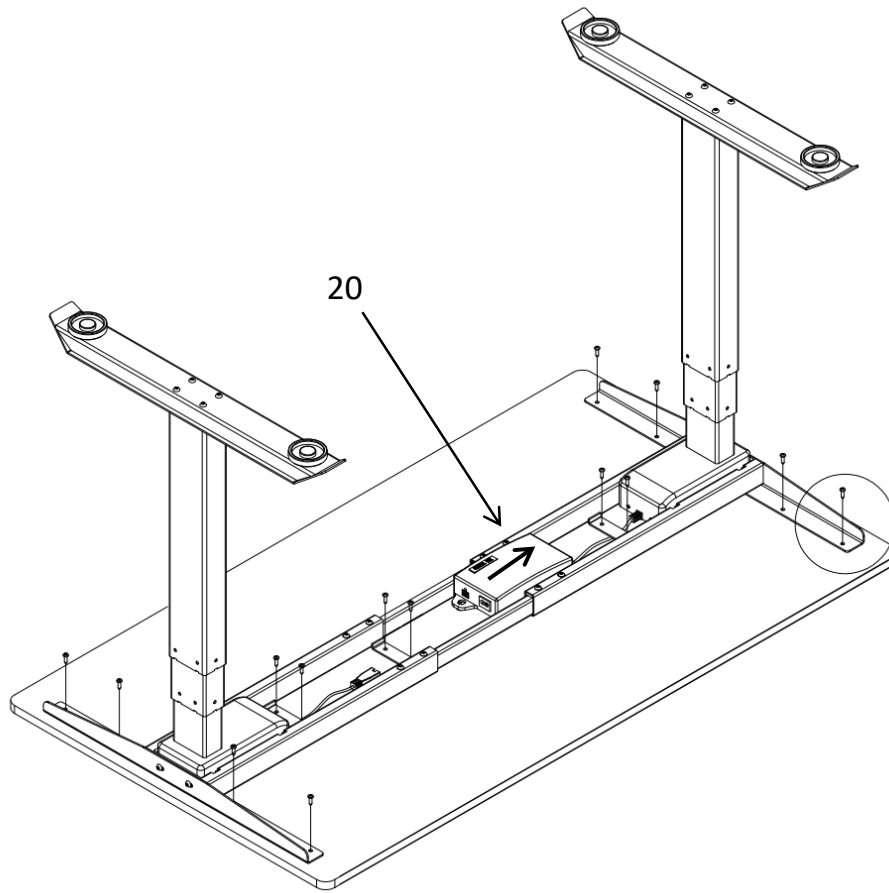
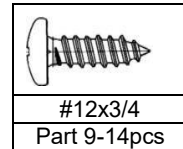

Note: Position Table Frame to on the center of the Worksurface.

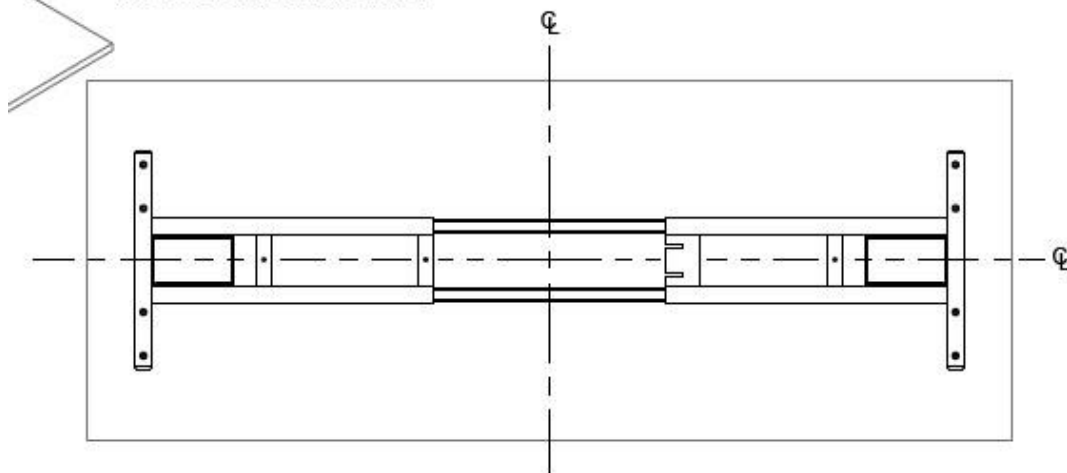

12. Install Handset x1(Part 21) with Screw x2(Part 14,#8x3/4).
Note: Cable Tie can be fixed under worksurface with #8x3/4.

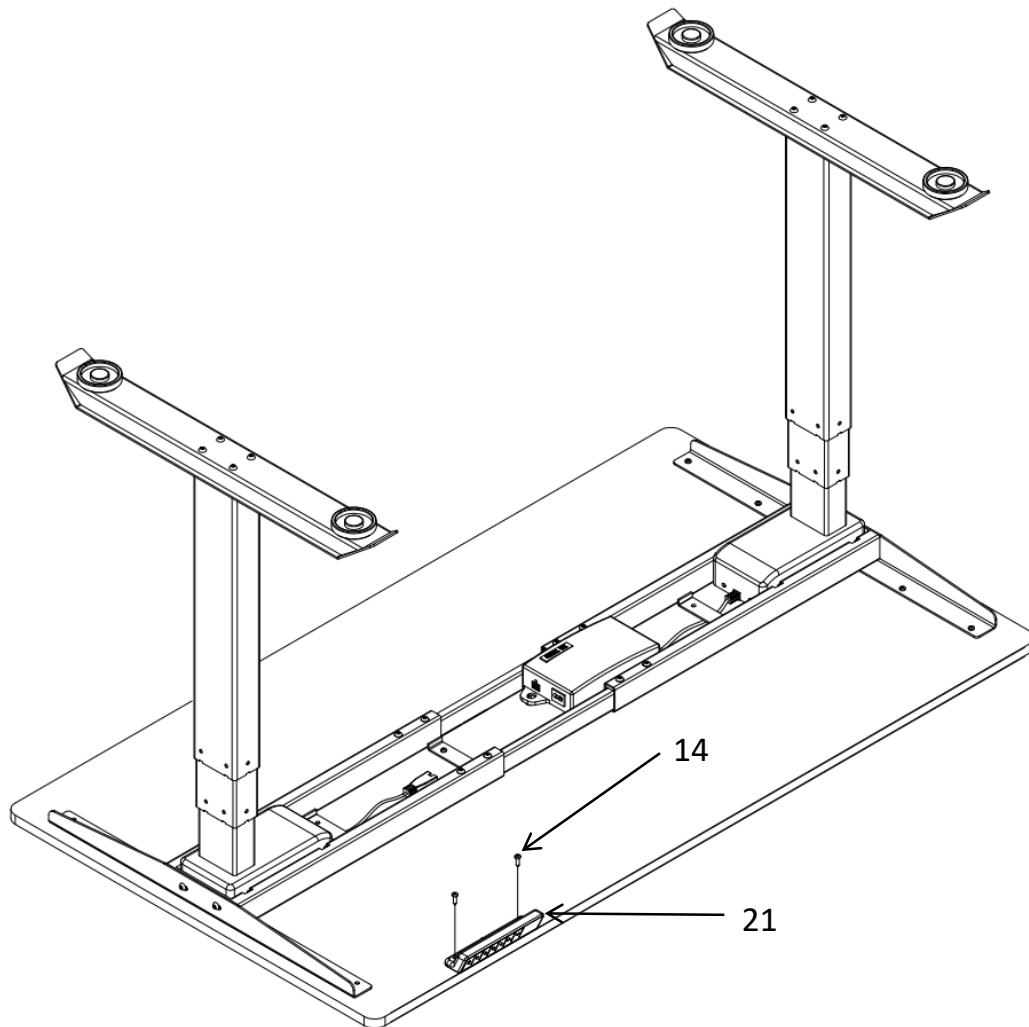
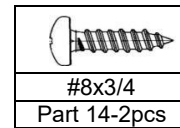

13. Attach Patch Cord x2 (Part 19) to 6 pin connector on Control box (Part 20)
And 6 pin connector to Lifting Column x2 (Part 2).
14. Attach Handset RJ45 connector (Part 21) to Control Box switch port (Part 20).
15. Install the Power Cord (Part 18) to Control Box (Part 20).
16. Plug Power Cord into Power Supply. Initialize table by pressing and holding down the down button on the handset for 5 seconds. The handset will display "RES" to confirm the reset command.
17. Table is ready for use. Consult User instructions for more display and calibration options.

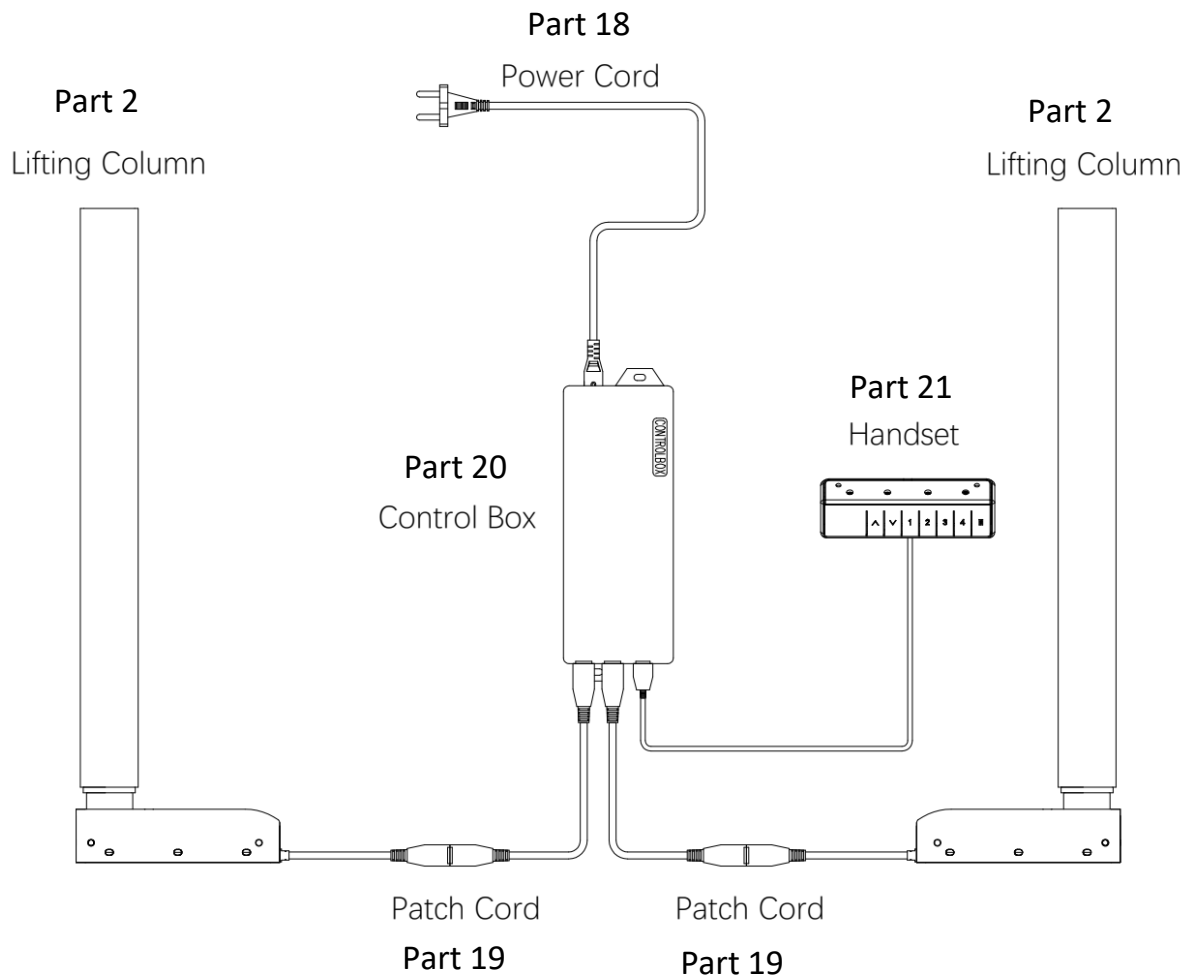



SAFETY NOTICE

Instability Hazard

Mobile items on casters such as flip top, personal and movable tables of any type and storage items of any type may present an instability hazard if not secured correctly while in use or in storage. Flip top tables or training tables of any type, are inherently more unstable when folded. BRC provides the following guidelines & warnings when using mobile products:

- Lock casters immediately after moving. Do not leave the casters unlocked when in use or in storage.
- Motion may increase the instability of any item with casters. If the wheels hit an obstruction the table's forward momentum often causes overturn, especially if the item is not equipped with wheel extensions. Exercise strong caution while moving these items.
- Use caution when abrupt level changes in the floor are present (such as a doorway or room threshold) as caster failure or tipping may result.
- Do not stand, sit or lean on mobile items for support. They are not intended for this use and personal injury or property damage may result.
- Mobile units that feature height adjustable elements must be lowered to the minimum compressed height when moving to prevent instability. It is also recommended the user remove all computer equipment or other accessories to prevent possible weight imbalance or damage to equipment.
- Failure to follow the guidelines above may result in property damage or personal injury.

Heavy Load

- This product must be anchored to wall to ensure stability & safety.
- It is the owner and installers responsibility to ensure that the wall type and construction is of sufficient strength to carry the loads of any wall mounted products and their contents.
- Failure of the wall and anchors to support all imposed loads may result in property damage or personal injury.
- BRC can provide size and empty weight of its products only. As wall blocking is considered a building construction process, BRC cannot provide recommendations in this respect and cannot be responsible for damage or injury that may occur as a result of improper installation and/or blocking.

Load Bottom Drawer First!

- Operate one drawer at a time.
- Unit may tip if loaded incorrectly.
- Unit should be attached to a wall or other furniture to reduce tipping hazard.
- Always load the heaviest files in the bottom drawer.
- Failure to follow the guidelines above may result in property damage or personal injury.