

Mesa - 2 Leg Desk Assembly Instructions

a. Assembly Diagram

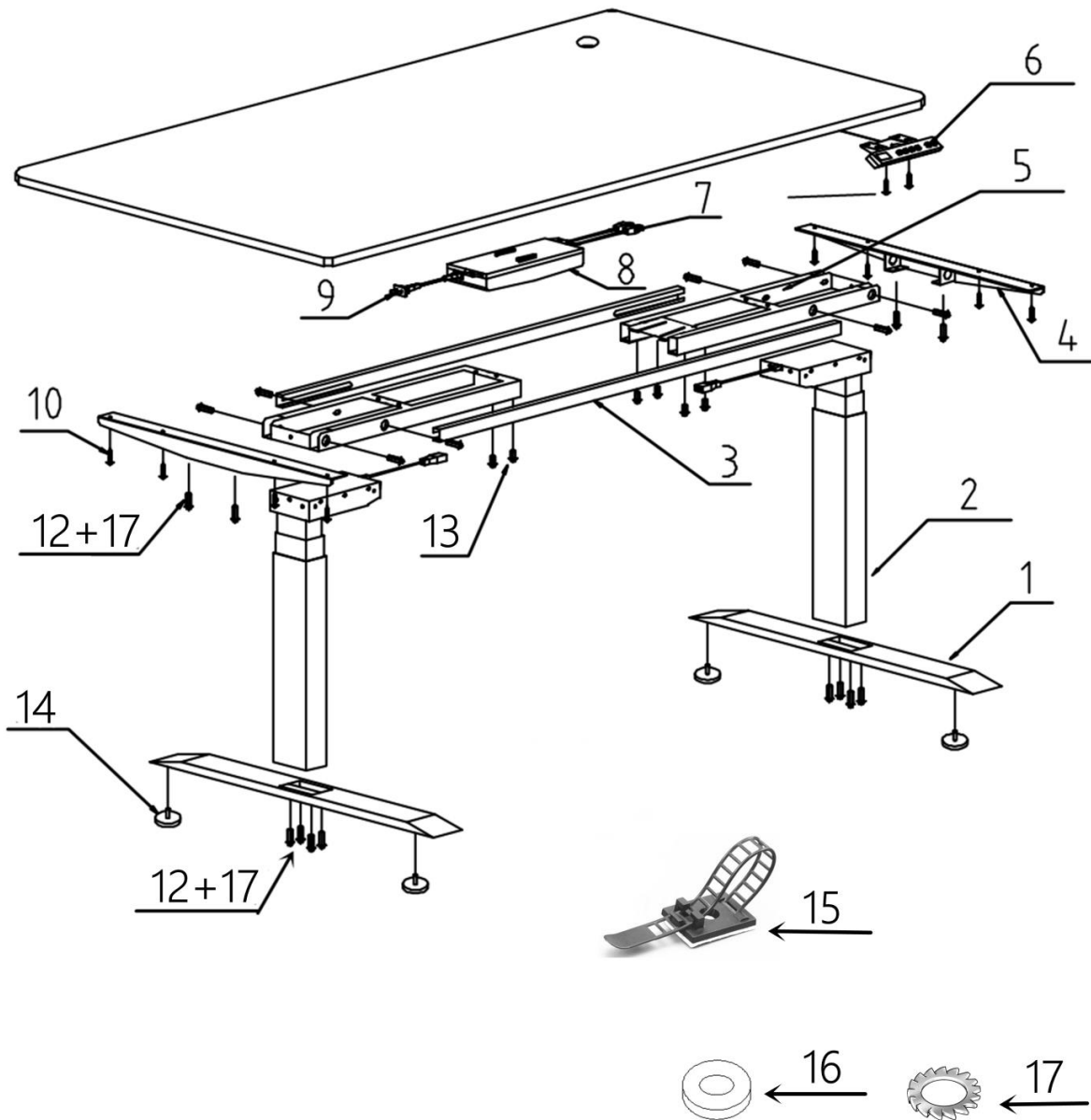

b. Packing list

Base Frame Components

1. Foot	-----	2pcs
2. Lifting Column	-----	2pcs
3. Extendable Tube	-----	2pcs
4. Side Support	-----	2pcs
5. Framework	-----	2pcs

Electrical Components

6. Handset	-----	1pc
7. Patch Cord-59"	-----	2pc
8. Control Box	-----	1pc
9. Power Cord-108"	-----	1pc

Hardware Components

10. Screw #12x3/4	-----	17pcs
11. Screws #8x3/4	-----	11pcs
12. Bolt M6x16	-----	20pcs
13. Bolt M6x10	-----	8pcs
14. Leveling Glide-1"	-----	4pcs
15. Cable Tie	-----	5pcs
16. Rubber Pad	-----	16pcs
17. Star Washer	-----	20pcs
18. 4mm Hex Wrench -Ball Point	-----	1pcs
19. 4mm Hex Bit	-----	1pcs

c. How to Set Up the Base Frame.

1. Install Rubber Pads on top of lifting column x 4 (Part 16).
2. Install framework x1 (Part 5) on lifting columns x1 (Part 2) with Screws x4 (Part 12) and Star Washers x4 (Part 17).

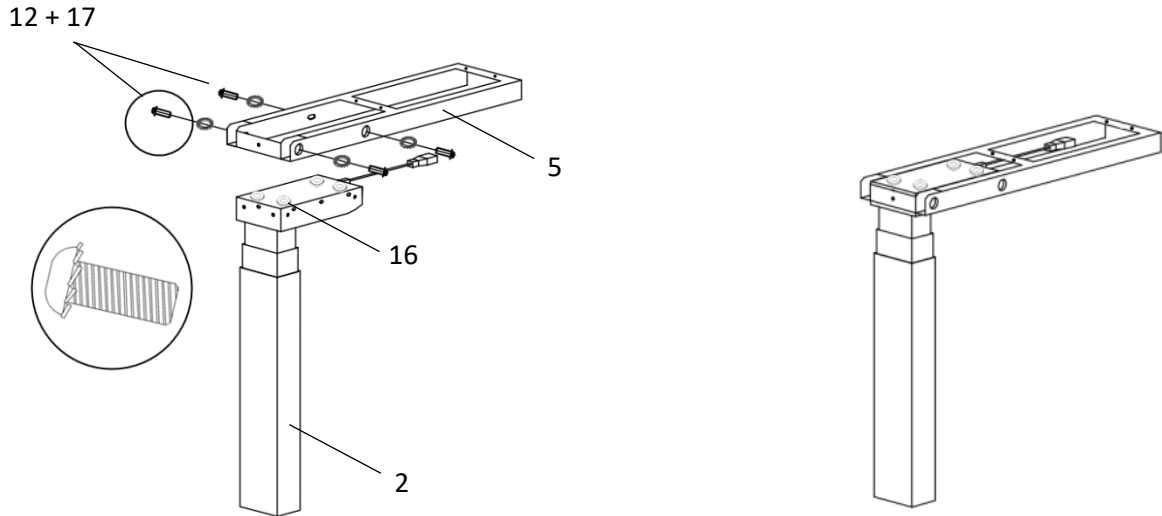

3. Install Side Support (Part 4) with Screw x2 (Part 12) and Star Washer x2 (Part 17) To Framework (Part 5).

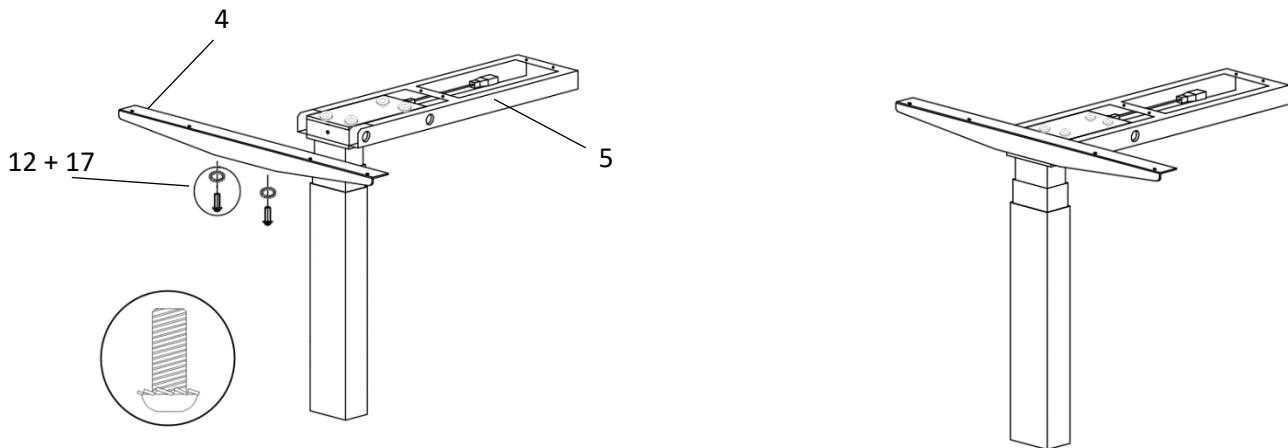

4. Install Foot x1 (Part 1) and Leveling Glide x2 (Part 14).
5. Install Foot x1 (Part 1) on Lifting Column x1 (Part 2) with Screws x4 (Part 12) and Star Washers x4 (Part 17).
6. Repeat Steps 1 to 5 for second leg assembly.

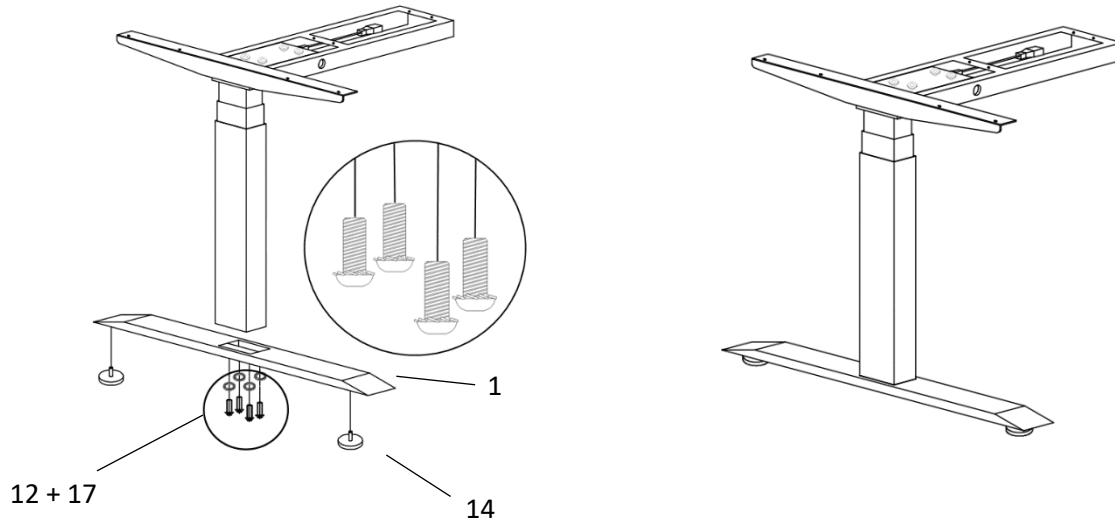

7. Insert Extendable Tube x2 (Part 3) into open Framework Ends x2 (Part 5)
8. Set width of base (Dim B) according to width of table top (Dim A). Refer to grid below. Tighten bolts x 8 (Part 13) to set the base frame to the correct width.

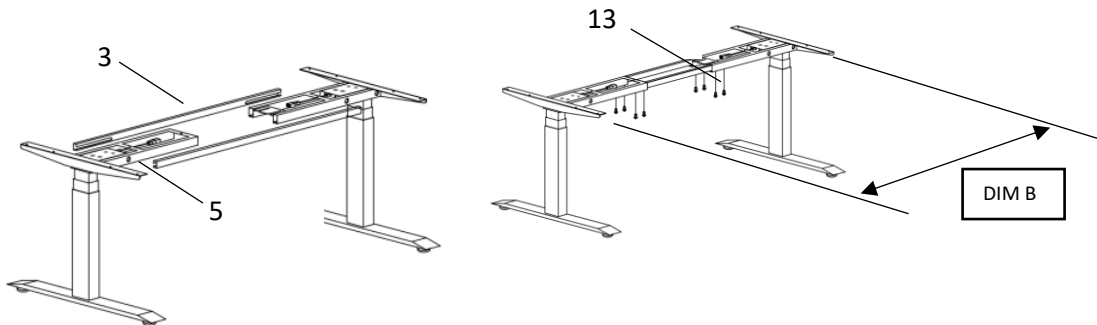

Nominal Width	Dimension	
	A Top Width	B Base Width
83	83.5	72
77	77.5	72
71	71.5	69.5
59	59.5	57.5
47	47.5	45.5

9. Install desktop, position in the center of the top as pictured below.
10. Use screws x16 (Part 10) to attach the base to the table top.

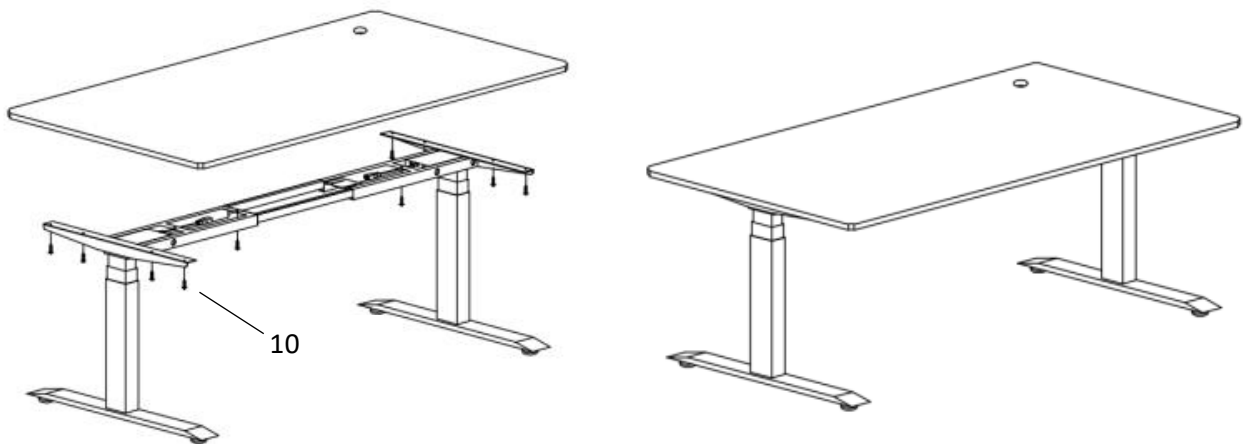
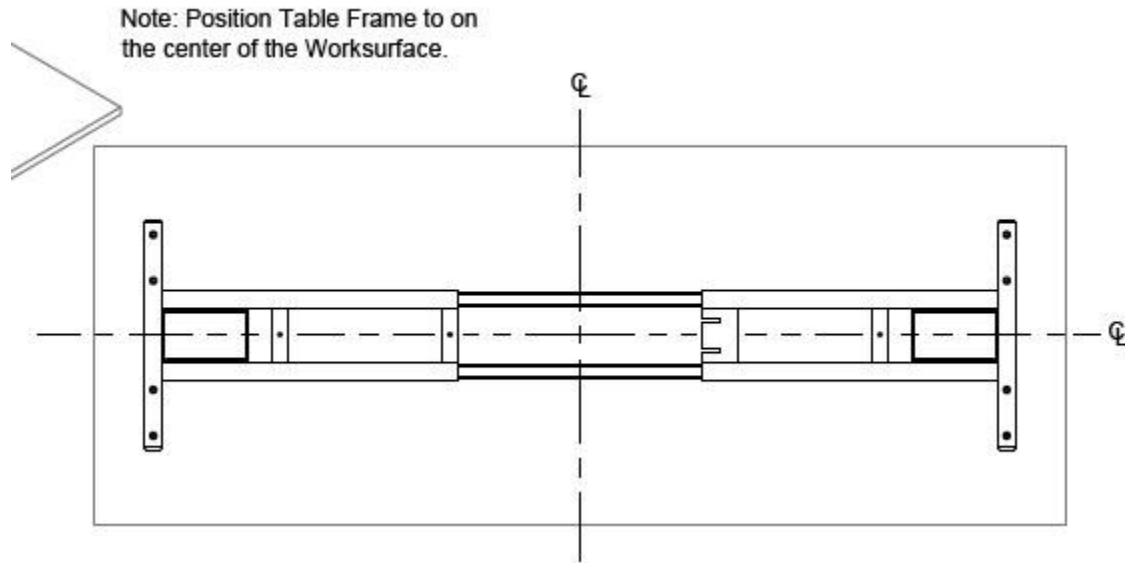

11. Install the control box x1 (Part 8) using screws x 2 (Part 11) and the Handset x1 (Part 6) using a screwdriver and screws x 2 (Part 11).
12. Attach Patch Cords x2 (Part 7) to 6 Pin connector on Control box (Part 8) and 6 Pin connector on Lifting columns (Part 2).
13. Attach handset RJ45 connector (Part 6) to Control Box switch port (Part 8).
14. Install the power cord (Part 9) to Control Box (Part 8).
15. Plug power cord in to power supply.
16. Initialize table by pressing and holding down the down button on the handset. The handset will display "RES" to confirm the reset command.
17. Table is ready for use.
18. Consult User instructions for more display and calibration options.

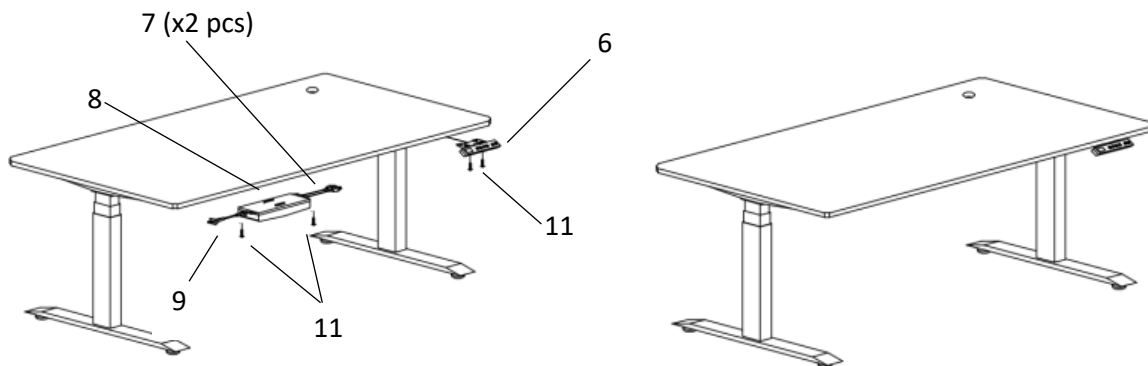



SAFETY NOTICE

Instability Hazard

Mobile items on casters such as flip top, personal and movable tables of any type and storage items of any type may present an instability hazard if not secured correctly while in use or in storage. Flip top tables or training tables of any type, are inherently more unstable when folded. BRC provides the following guidelines & warnings when using mobile products:

- Lock casters immediately after moving. Do not leave the casters unlocked when in use or in storage.
- Motion may increase the instability of any item with casters. If the wheels hit an obstruction the table's forward momentum often causes overturn, especially if the item is not equipped with wheel extensions. Exercise strong caution while moving these items.
- Use caution when abrupt level changes in the floor are present (such as a doorway or room threshold) as caster failure or tipping may result.
- Do not stand, sit or lean on mobile items for support. They are not intended for this use and personal injury or property damage may result.
- Mobile units that feature height adjustable elements must be lowered to the minimum compressed height when moving to prevent instability. It is also recommended the user remove all computer equipment or other accessories to prevent possible weight imbalance or damage to equipment.
- Failure to follow the guidelines above may result in property damage or personal injury.

Heavy Load

- This product must be anchored to wall to ensure stability & safety.
- It is the owner and installers responsibility to ensure that the wall type and construction is of sufficient strength to carry the loads of any wall mounted products and their contents.
- Failure of the wall and anchors to support all imposed loads may result in property damage or personal injury.
- BRC can provide size and empty weight of its products only. As wall blocking is considered a building construction process, BRC cannot provide recommendations in this respect and cannot be responsible for damage or injury that may occur as a result of improper installation and/or blocking.

Load Bottom Drawer First!

- Operate one drawer at a time.
- Unit may tip if loaded incorrectly.
- Unit should be attached to a wall or other furniture to reduce tipping hazard.
- Always load the heaviest files in the bottom drawer.
- Failure to follow the guidelines above may result in property damage or personal injury.

11/2022