

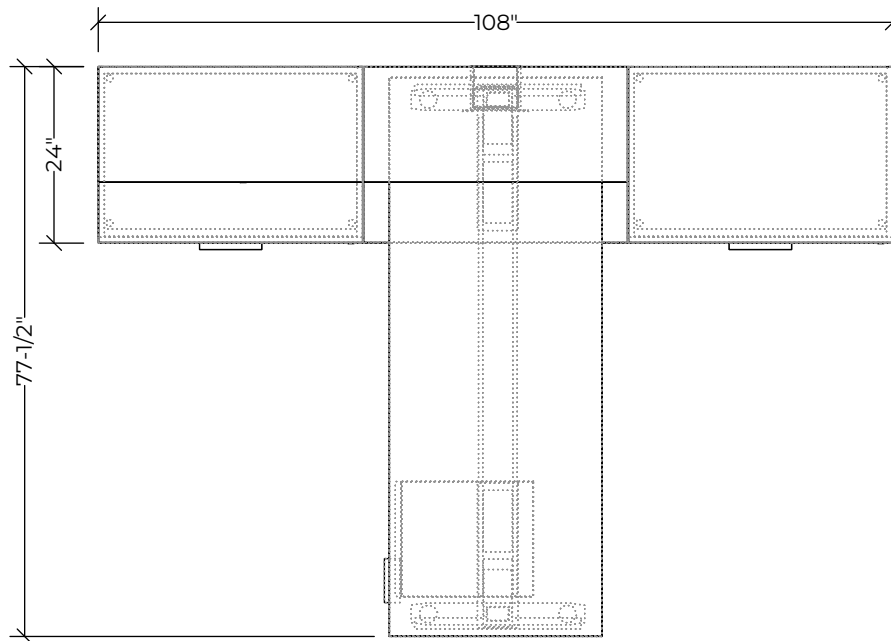

Please refer to page 2 for list pricing information.



#	Catalogue Part Number	Description	Quantity	List	Ext. List
1	QSN QMWSTCW76D29M1	Mesa Rectangular 2 Leg Electric T Base Table Sit-Stand,76Wx29D,M1 Laminate	1	\$2,744.00	\$2,744.00
2	QSN QN1BFMW15.75D18.75H21.25M3	Mobile Pedestal Box File,15.75Wx18.75Dx21.25H,M3 Laminate	1	\$1,112.00	\$1,112.00
3	QSN QNAMLAW46H12	Modesty Panel, Laminate 46Wx12H, Laminate	1	\$600.00	\$600.00
4	QSN QNFMSZW36D24H22.25M1	Modular Integrated Leg Cabinet - 22.25"H, Full Front,36Wx24Dx22.25H,M1 Laminate	1	\$1,927.00	\$1,927.00
5	QSN QNLLSZW36D24H22.25M1	Low Lateral Box File with Top, Full Front 36Wx24Dx22.25H,M1 Laminate	2	\$1,284.00	\$2,568.00
6	QSN QNZCLNW36D15.75H15M1	Wall Mounted Hinged Door Cabinet 36Wx15.75Dx15H,M1 Laminate	1	\$1,049.00	\$1,049.00
7	QSN QNZOPNW36D15.75H15M1	Wall Mounted Open Front Storage 36Wx15.75Dx15H,M1 Laminate	1	\$687.00	\$687.00
				Total (Sell)	\$10,687.00

Pricing is for budgetary reference only and is subject to change. Availability of finishes and materials may vary due to manufacturer lifecycle updates. Explore more Idea Starters at www.brc.group/natural-quick-ship.