

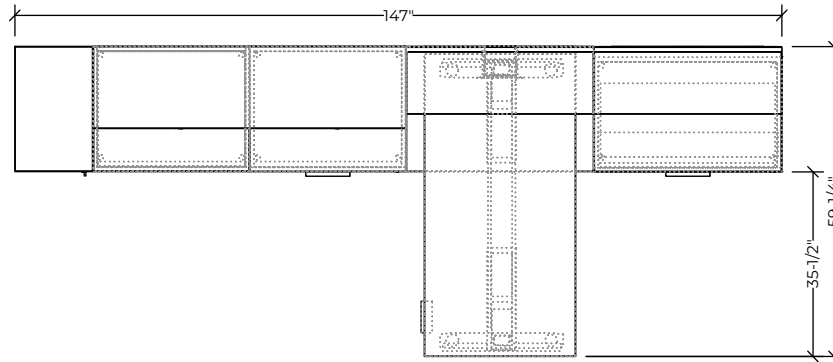

Please refer to page 2 for list pricing information.



#	Part Number	OptionsDescription	Catalogue	Complete	Quantity	List	Ext. List
BRC GROUP							
BRC GROUP							
1	QMWSTCW58D29M1	Mesa Rectangular 2 Leg Electric T Base Table Sit-Stand,58Wx29D,M1 Laminate	QSN	N	1	\$2,431.00	\$2,431.00
2	QNEFFW36D13H17	Element Free Panel Floating One Shelf 36Wx13Dx17H	QSN	Y	1	\$552.00	\$552.00
3	QNEFSDW36D13H37A	Element Desk Height Laminate Panel 36Wx13Dx37H, 1 Shelf	QSN	Y	1	\$676.00	\$676.00
4	QNFMSZW36D24H22.25M1	Modular Integrated Leg Cabinet - 22.25"H, Full Front,36Wx24Dx22.25H,M1 Laminate	QSN	N	1	\$1,927.00	\$1,927.00
5	QNLLSZW30D24H22.25M1	Low Lateral Box File with Top, Full Front 30Wx24Dx22.25H,M1 Laminate	QSN	Y	1	\$1,333.00	\$1,333.00
6	QNLOSZW30D24H22.25M1	Low Open Storage With Top Full Front 30Wx24Dx22.25H,M1 Laminate	QSN	Y	1	\$1,089.00	\$1,089.00
7	QNSUFZW36D22H28	Undermount 2 Drawer Lateral, Full Front,36Wx22Dx28H	QSN	Y	1	\$1,505.00	\$1,505.00
8	QNTOPNW36D24M1	Component Worksurface & Panel 36Wx24D,M1 Laminate	QSN	N	1	\$294.00	\$294.00
9	QNWTCZW15D24H66M1L	Closed Wardrobe Single Door Full Front 15Wx24Dx66H,M1 Laminate,Left Hinged	QSN	Y	1	\$1,567.00	\$1,567.00
10	QNZCLNW60D15.75H15M1	Wall Mounted Hinged Door Cabinet 60Wx15.75Dx15H,M1 Laminate	QSN	Y	1	\$1,220.00	\$1,220.00
						Total BRC GROUP	\$12,594.00
						Total BRC GROUP	\$12,594.00
						Components (Sell)	\$12,594.00
						Discount (0 %)	\$0.00
						Freight	\$0.00
						Packing	\$0.00
						Assembly	\$0.00
						Environmental fees	\$0.00
						Round up/down	(\$4.00)
						Total (Sell)	\$12,590.00

Pricing is for budgetary reference only and is subject to change. Availability of finishes and materials may vary due to manufacturer lifecycle updates. Explore more Idea Starters at www.brc.group/natural-quick-ship.