

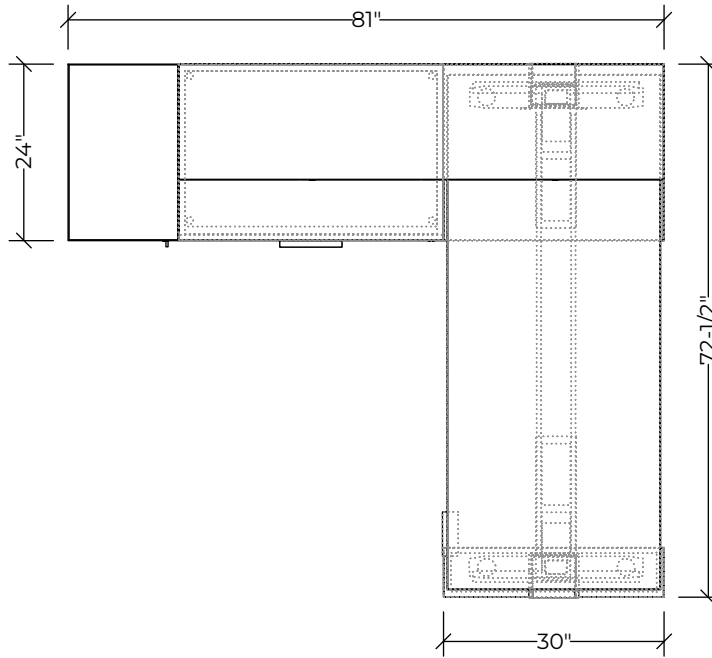

Please refer to page 2 for list pricing information.



#	Catalogue Part Number	Description	Quantity	List	Ext. List
1	QSN QMWSTCW70D29M1	Mesa Rectangular 2 Leg Electric T Base Table Sit-Stand,70Wx29D,M1 Laminate	1	\$2,431.00	\$2,431.00
2	QSN QNAMLAW34H12	Modesty Panel, Laminate 34Wx12H, Laminate	1	\$553.00	\$553.00
3	QSN QNFMSZW30D24H22.25M1	Modular Integrated Leg Cabinet - 22.25"H, Full Front,30Wx24Dx22.25H,M1 Laminate	1	\$1,898.00	\$1,898.00
4	QSN QNFSSZW6.75D30H22.25M1L	Height Adjustable Leg Surround - 22.25"H,6.75Wx30D,M1 Laminate,Left Hand	1	\$930.00	\$930.00
5	QSN QNLLSZW36D24H22.25M1	Low Lateral Box File with Top, Full Front 36Wx24Dx22.25H,M1 Laminate	1	\$1,284.00	\$1,284.00
6	QSN QNWT CZW15D24H66M1L	Closed Wardrobe Single Door Full Front 15Wx24Dx66H,M1 Laminate,Left Hinged	1	\$1,567.00	\$1,567.00
7	QSN QNZCLNW66D15.75H15M1	Wall Mounted Hinged Door Cabinet 66Wx15.75Dx15H,M1 Laminate	1	\$1,271.00	\$1,271.00
				Total (Sell)	\$9,934.00

Pricing is for budgetary reference only and is subject to change. Availability of finishes and materials may vary due to manufacturer lifecycle updates. Explore more Idea Starters at www.brc.group/natural-quick-ship.